

## Maximum Efficiency Right-angle Gearmotors 712 115/230V Single Phase Dual Voltage/Dual Frequency

PowerSTAR® 712 Series 115/230V dual voltage/dual frequency single phase right-angle gearmotor offers up to 240 in-lbs of torque running continuously for reliable and energy efficient

### 712 Series 1PH 115/230V Dual Voltage/Dual Frequency Gearmotor - TENV\*

Part Number	Rated Speed (RPM)		Torque (in-lbs)		Input HP	Gear Ratio	Stages	Rated Current 115V		Rated Current 230V	
	50	60	50	60				50	60	50	60
026-712E0010	132	163	12	10	1/30	10	2	0.5	0.45	0.3	0.3
026-712E0015	88	108	17	15	1/30	15	2	0.5	0.45	0.3	0.3
026-712E0020	66	81	22	20	1/30	20	2	0.5	0.45	0.3	0.3
026-712E0030	44	54	32	30	1/30	30	2	0.5	0.45	0.3	0.3
026-712E0040	33	41	42	40	1/30	40	2	0.5	0.45	0.3	0.3
026-712E0050	26	33	52	50	1/30	50	2	0.5	0.45	0.3	0.3
026-712E0060	22	27	62	60	1/30	60	2	0.5	0.45	0.3	0.3
026-712E0080	17	20	82	80	1/30	80	3	0.5	0.45	0.3	0.3
026-712E0100	13	16	105	100	1/30	100	3	0.5	0.45	0.3	0.3
026-712E0120	11	14	125	120	1/30	120	3	0.5	0.45	0.3	0.3
026-712E0150	8.8	11	155	150	1/30	150	3	0.5	0.45	0.3	0.3
026-712E0180	7.3	9.3	185	180	1/30	180	3	0.5	0.45	0.3	0.3
026-712E0200	6.6	8.1	205	200	1/30	200	3	0.5	0.45	0.3	0.3
026-712E0240	5.5	6.8	245	240	1/30	240	3	0.5	0.45	0.3	0.3

\*Capacitors required - Please reference Part Number: 225-712-0002

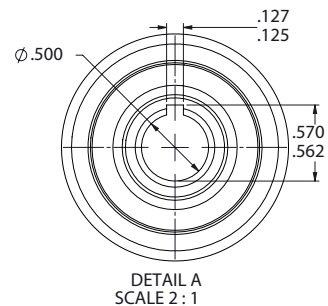
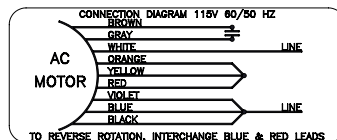
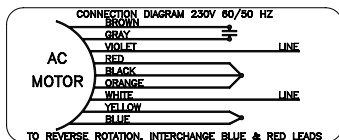
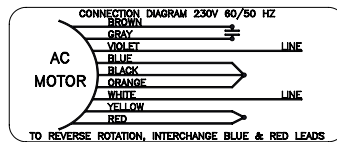
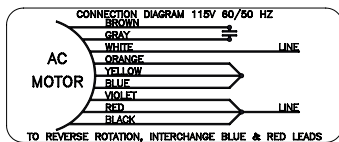
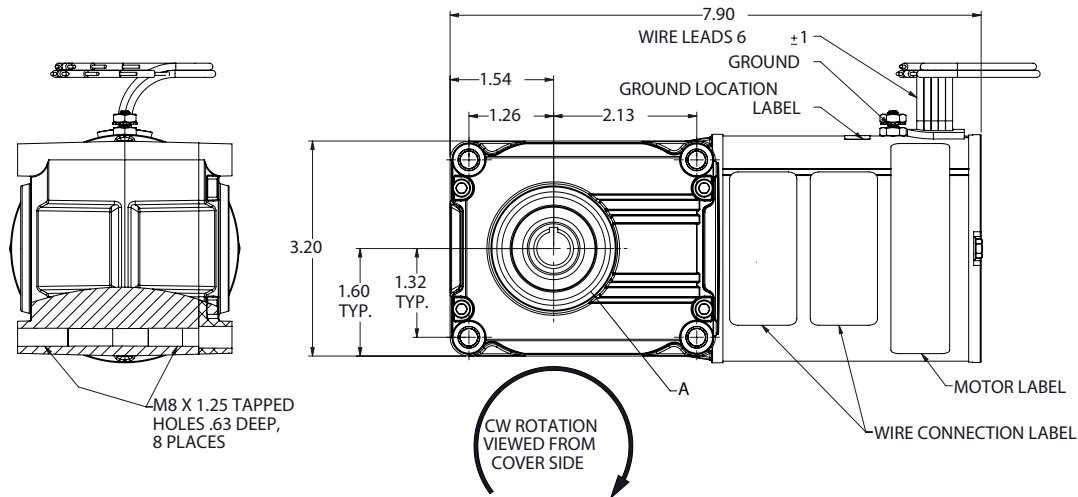

CONNECTION DIAGRAM LABEL FOR 2 STAGE GEARBOX

CONNECTION DIAGRAM LABEL FOR 3 STAGE GEARBOX